



DEPARTMENT OF THE ARMY
NEW ORLEANS DISTRICT, CORPS OF ENGINEERS
P.O. BOX 60267
NEW ORLEANS, LOUISIANA 70160-0267

January 4, 2016

REPLY TO
ATTENTION OF

Operations Division
Eastern Evaluation Section

Project Manager
Kara Vick
Kara.Vick@usace.army.mil
(504) 862-2279

SUBJECT: MVN 2015-02469-EV

PUBLIC NOTICE

Interested parties are hereby notified that an application has been received by the District engineer for a Department of the Army permit to authorize the following pursuant to (X) Section 10 of the Rivers and Harbors Act of March 3, 1899 (30 Stat. 1151; 33 USC 403); and/or () Section 404 of the Clean Water Act (86 Stat. 816; 33 USC 1344).

**CONSTRUCT A BOATSHED IN BAYOU LA LOUTRE
IN SAINT BERNARD PARISH**

NAME OF APPLICANT: N & N Construction, LLC, Attn: Debbie Mones, 435 Bayou Road, St. Bernard, Louisiana 70085.

LOCATION OF WORK: Along Bayou La Loutre, at 4210 Hopedale Highway, in Hopedale, Louisiana, in Saint Bernard Parish, as shown on the attached drawings.

HUC: 08090203: Lower Mississippi Region - Lake Pontchartrain
Latitude: 29.827511 Longitude: -89.672360

CHARACTER OF WORK: Construct a 38' x 92' covered boatshed. Work will be conducted by barge mounted pile driver. No dredging and/or fill activities are proposed. The applicant maintains that no jurisdictional wetlands would be directly affected by this action, thus no compensatory mitigation is anticipated.

The comment period will close 15 days from the date of this public notice advertisement. Written comments, including suggestions for modifications or objections to the proposed work, stating reasons therefore, are being solicited from anyone having interest in this permit request. Letters must reference the applicant's name and the subject number, be addressed and mailed to the above address, ATTENTION: REGULATORY BRANCH. Individuals or parties may request an extension of time in which to comment on the proposed work by writing or e-mailing the Corps of Engineers Project Manager listed above. Any request must be specific and substantively

supportive of the requested extension, and received by this office prior to the end of the initial comment period. The Section Chief will review the request and the requestor will be promptly notified of the decision to grant or deny the request. If granted, the time extension will be continuous to the initial comment period and, inclusive of the initial comment period, will not exceed a total of 30 calendar days.

Corps of Engineers Permit Criteria

The decision whether to issue a permit will be based on an evaluation of the probable impacts, including cumulative impacts of the proposed activity on the public interest. That decision will reflect the national concern for both protection and utilization of important resources. The benefit which reasonably may be expected to accrue from the proposal must be balanced against its reasonably foreseeable detriments. All factors which may be relevant to the proposal will be considered including the cumulative effects thereof; among those are conservation, economics, aesthetics, general environmental concerns, wetlands, historic properties, fish and wildlife values, flood hazards, floodplain values, land use, navigation, shoreline erosion and accretion, recreation, water supply and conservation, water quality, energy needs, safety, food and fiber production, mineral needs, considerations of property ownership and, in general, the needs and welfare of the people.

The U.S. Army Corps of Engineers is soliciting comments from the public, federal, state, and local agencies and officials, Indian Tribes, and other interested parties in order to consider and evaluate the impacts of this proposed activity. Any comments received will be considered by the U.S. Army Corps of Engineers to determine whether to make, modify, condition, or deny a permit for this proposal. To make this decision, comments are used to assess impacts on endangered species, historic properties, water quality, general environmental effects, and other public interest factors listed above. Comments are used in the preparation of an Environmental Assessment and/or an Environmental Impact Statement pursuant to the National Environmental Policy Act. Comments are also used to determine the need for a public hearing and to determine the overall public interest of the proposed activity.

The New Orleans District is unaware of properties listed on the National Register of Historic Places near the proposed work. The possibility exists that the proposed work may damage or destroy presently unknown archeological, scientific, prehistorical, historical sites, or data. Issuance of this public notice solicits input from the State Archeologist and State Historic Preservation Officer regarding potential impacts to cultural resources.

Our initial finding is that the proposed work would not affect any species, nor affect any habitat designated as critical to the survival and recovery of such species, listed as endangered by the U.S. Department of Commerce.

The New Orleans District has determined that the project footprint is located in waters known to be utilized by the West Indian Manatee and determined the activity is "not likely to adversely affect" this species based on the Standard Local Operating Procedure for Endangered Species in Louisiana (SLOPES), dated October 22, 2014, between the U.S. Army Corps of Engineers, New Orleans and U.S. Fish and Wildlife Service, Ecological Services Office.

This notice initiates the Essential Fish Habitat (EFH) consultation requirements of the Magnuson-Stevens Fishery Conservation and Management Act. The applicant's proposal would result in the destruction or alteration of up to 0.0 acres of EFH utilized by various life stages of red drum and penaeid shrimp. Our initial determination is that the proposed action would not have a substantial adverse impact on EFH or federally managed fisheries in the Gulf of Mexico. Our final determination relative to project impacts and the need for mitigation measures is subject to review by and coordination with the National Marine Fisheries Service.

If the proposed work involves deposits of dredged or fill material into navigable waters, the evaluation of the probable impacts will include the application of guidelines established by the Administrator of the Environmental Protection Agency. Also, a certification that the proposed activity will not violate water quality standards will be required from the Department of Environmental Quality, Water Quality Certifications Section before a permit is issued.

Any person may request, in writing, within the comment period specified in this notice, that a public hearing be held to consider this application. Requests for public hearings shall state, with particularity, the reasons for holding a public hearing.

The applicant has certified that the proposed activity described in the application complies with and will be conducted in a manner that is consistent with the Louisiana Coastal Resources Program. The Department of the Army Permit will not be issued unless the applicant received approval or a waiver of the Coastal Use Permit by the Department of Natural Resources.

You are requested to communicate the information contained in this notice to any other parties whom you deem likely to have interest in the matter.

Michael V. Farabee
Chief, Eastern Evaluation Section

Enclosure

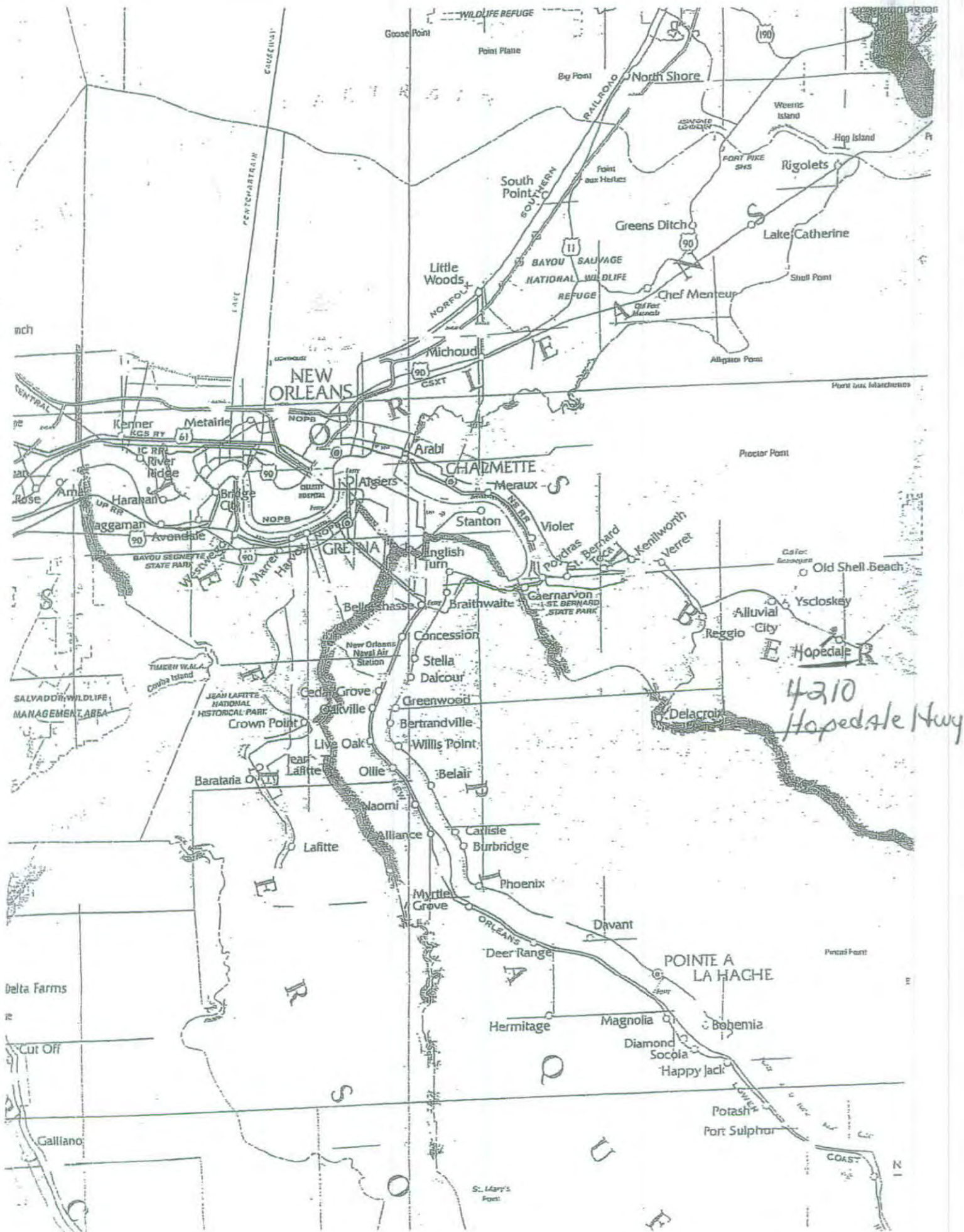



Google Maps

4210 hopedale hwy



Map data ©2015 Google 20 ft

Proposed BOAT Shed for RALPH Kieff

29° 49' 40.01" N 4210 HopeDALE Hwy.

89° 40' 21.03" W Bayou LA Loutre

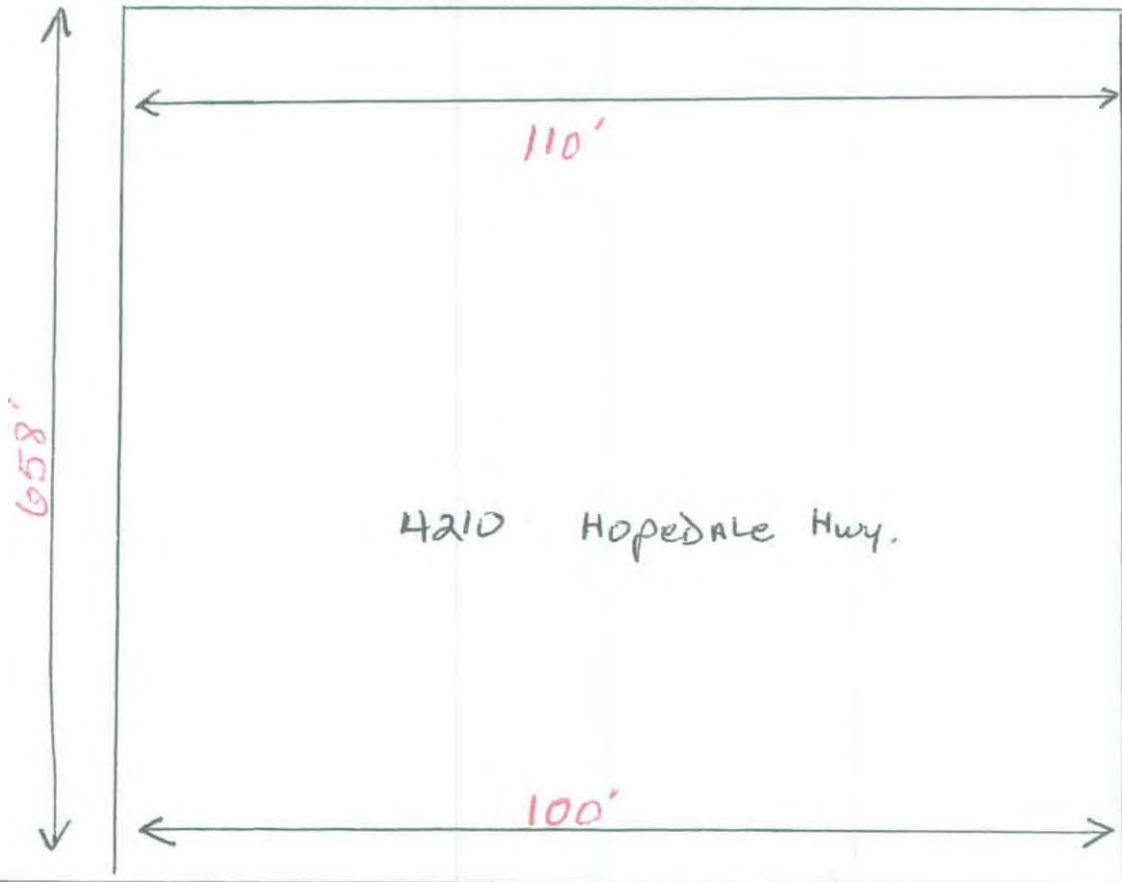

HopeDALE Hwy.

R

R

Proposed BOAT Shed
38' x 92'

29° 49' 40.01" N

89° 40' 21.03" W

PROPOSED BOATSHED for RALPH KIEFF
4210 HOPEDALE HWY.

BAYOU LA LOUISE

N

opposite Bank

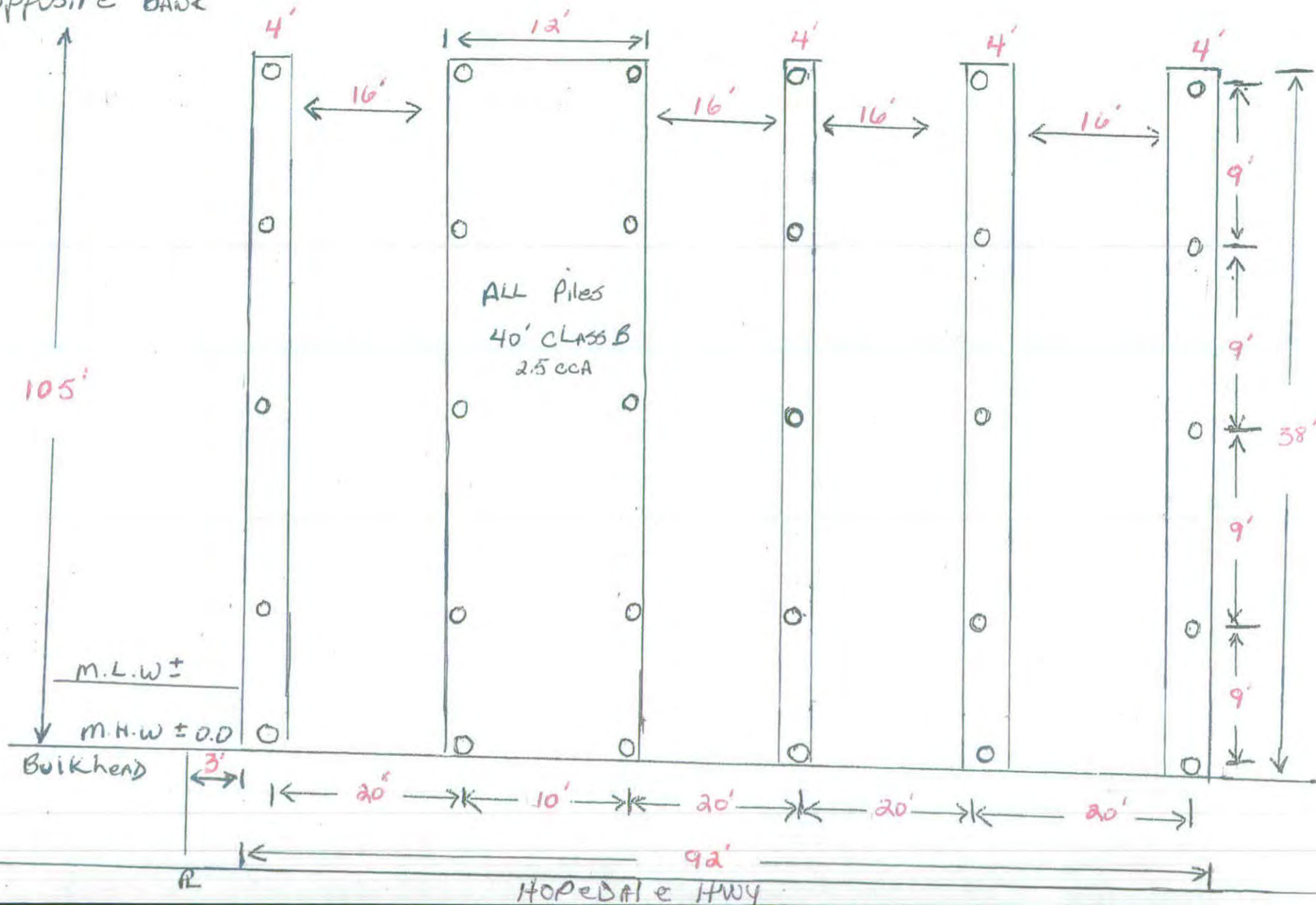

29° 49' 40.01 N
89° 40' 21.03 W

PROPOSED BOAT SHED for Ralph Kieff
4210 HOPEDALE HWY.
BAYOU LA LOUTRE

