

JOINT PUBLIC NOTICE

May 23, 2016

United States Army Corps of Engineers
New Orleans District
Regulatory Branch
Post Office Box 60267
New Orleans, Louisiana 70160-0267

(504) 862-2099
Project Manager
Stephen Pfeffer
stephen.d.pfeffer@usace.army.mil
MVN 2015-02110-MS

State of Louisiana
Department of Environmental Quality
Office of Environmental Services
Post Office Box 4313
Baton Rouge, Louisiana 70821-4313

(225) 219-3026
Project Manager
Terriana Wilcox
WQC Application Number
WQC 160520-01

Interested parties are hereby notified that a permit application has been received by the New Orleans District of the US Army Corps of Engineers pursuant to: [] Section 10 of the Rivers and Harbors Act of March 3, 1899 (30 Stat. 1151; 33 USC 403); and/or [X] Section 404 of the Clean Water Act (86 Stat. 816; 33 USC 1344).

Application has also been sent to the Louisiana Department of Environmental Quality, Office of Environmental Services, for a Water Quality Certification (WQC) in accordance with statutory authority contained in LRS 30:2074 A(3) and provisions of Section 401 of the Clean Water Act.

CONSTRUCTION OF AN INTERCHANGE AT INTERSTATE 10 AND PECUE LANE IN EAST BATON ROUGE PARISH

NAME OF APPLICANT: City of Baton Rouge, c/o Shread-Kuyrkendall & Associates, Inc., 13016 Justice Avenue, Baton Rouge, Louisiana 70816.

LOCATION OF WORK: The project is located at the intersection of Interstate 10 and Pecue Lane, in Sections 5, 48 and 49, Township 8 South, Range 2 East, in Baton Rouge, Louisiana, in East Baton Rouge Parish, as shown on the enclosed drawings (Latitude 30.36825° N, Longitude 91.04681° W). This project is located in Lake Ponchartrain watershed basin within the Amite River USGS Catalog Unit 08070202.

CHARACTER OF WORK: The applicant has requested Department of the Army authorization to clear, grade, excavate and deposit fill and/or aggregate material to construct a highway interchange. The proposed project would impact approximately 6.3 acres of jurisdictional wetlands and 0.9 acre of "other waters of the US". The applicant has claimed that the project has been designed to avoid and minimize impacts as much as possible. Approximately 72,225 cubic yards of earthen fill material would be hauled in and deposited in jurisdictional wetlands to achieve required grade elevation. As compensation for unavoidable wetland impacts, the applicant proposes to use a Corps approved mitigation bank within the watershed of impact.

The comment period for the Department of Army will close in **20 days** from the date of this joint public notice. Written comments, including suggestions for modifications or objections to the proposed work, stating reasons thereof, are being solicited from anyone having interest in this permit and/or this WQC request and must be mailed so as to be received before or by the last day of the comment period. Letters concerning the Corps of Engineers permit application must reference the applicant's name and the Permit Application Number, and be mailed to the Corps of Engineers at the address above, **ATTENTION: REGULATORY BRANCH**. Individuals or parties may request an extension of time in which to comment on the proposed work by writing or e-mailing the Corps of Engineers Project Manager listed above. Any request must be specific and substantively supportive of the requested extension, and received by this office prior to the end of the initial comment period. The Section Chief will review the request and the requestor will be promptly notified of the decision to grant or deny the request. If granted, the time extension will be continuous to the initial comment period and, inclusive of the initial comment period, will not exceed a total of 30 calendar days. Similar letters concerning the Water Quality Certification must reference the applicant's name and the WQC Application number and be mailed to the Louisiana Department of Environmental Quality at the address above.

The application for this proposed project is on file with the Louisiana Department of Environmental Quality and may be examined during weekdays between 8:00 a.m. and 4:30 p.m. Copies may be obtained upon payment of costs of reproduction.

Corps of Engineers Permit Criteria

The decision whether to issue a permit will be based on an evaluation of the probable impacts, including cumulative impacts of the proposed activity on the public interest. That decision will reflect the national concern for both protection and utilization of important resources. The benefit which reasonably may be expected to accrue from the proposal must be balanced against its reasonably foreseeable detriments. All factors which may be relevant to the proposal will be considered including the cumulative effects thereof; among those are conservation, economics, aesthetics, general environmental concerns, wetlands, historic properties, fish and wildlife values, flood hazards, floodplain values, land use, navigation, shoreline erosion and accretion, recreation, water supply and conservation, water quality, energy needs, safety, food and fiber production, mineral needs, considerations of property ownership and, in general, the needs and welfare of the people.

The US Army Corps of Engineers is soliciting comments from the public, federal, state, and local agencies and officials, Indian Tribes, and other interested parties in order to consider and evaluate the impacts of this proposed activity. Any comments received will be considered by the US Army Corps of Engineers to determine whether to make, modify, condition, or deny a permit for this proposal. To make this decision, comments are used to assess impacts on endangered species, historic properties, water quality, general environmental effects, and other public interest factors listed above. Comments are used in the preparation of an Environmental Assessment and/or an Environmental Impact Statement pursuant to the National Environmental Policy Act. Comments are also used to

determine the need for a public hearing and to determine the overall public interest of the proposed activity.

The New Orleans District is unaware of properties listed on the National Register of Historic Places near the proposed work. The possibility exists that the proposed work may damage or destroy presently unknown archeological, scientific, prehistorical, historical sites, or data. Copies of the notice are being sent to the State Archeologist and State Historic Preservation Officer.

Our initial finding is that the proposed work would neither affect any species listed as endangered by the U.S. Departments of Interior or Commerce, nor affect any habitat designated as critical to the survival and recovery of any endangered species. Utilizing Standard Local Operating Procedure for Endangered Species in Louisiana (SLOPES), dated October 22, 2014, between the U.S. Army Corps of Engineers, New Orleans and U.S. Fish and Wildlife Service, Ecological Services Office, the Corps has determined that the proposed activity would have no effect on any listed species.

This notice initiates the Essential Fish Habitat (EFH) consultation requirements of the Magnuson-Stevens Fishery Conservation and Management Act. The applicant's proposal would result in the destruction or alteration of up to n/a acres of EFH utilized by various life stages of red drum and penaeid shrimp. Our initial determination is that the proposed action would not have a substantial adverse impact on EFH or federally managed fisheries in the Gulf of Mexico. Our final determination relative to project impacts and the need for mitigation measures is subject to review by and coordination with the National Marine Fisheries Service.

If the proposed work involves deposits of dredged or fill material into navigable waters, the evaluation of the probable impacts will include the application of guidelines established by the Administrator of the Environmental Protection Agency. Also, a certification that the proposed activity will not violate water quality standards will be required from the Department of Environmental Quality, Office of Environmental Services before a permit is issued.

Any person may request, in writing, within the comment period specified in this notice, that a public hearing be held to consider this application. Requests for public hearings shall state, with particularity, the reasons for holding a public hearing. You are requested to communicate the information contained in this notice to any other parties whom you deem likely to have interest in the matter.

JOHN M. HERMAN
Chief, Central Evaluation Section
Regulatory Branch

Enclosures

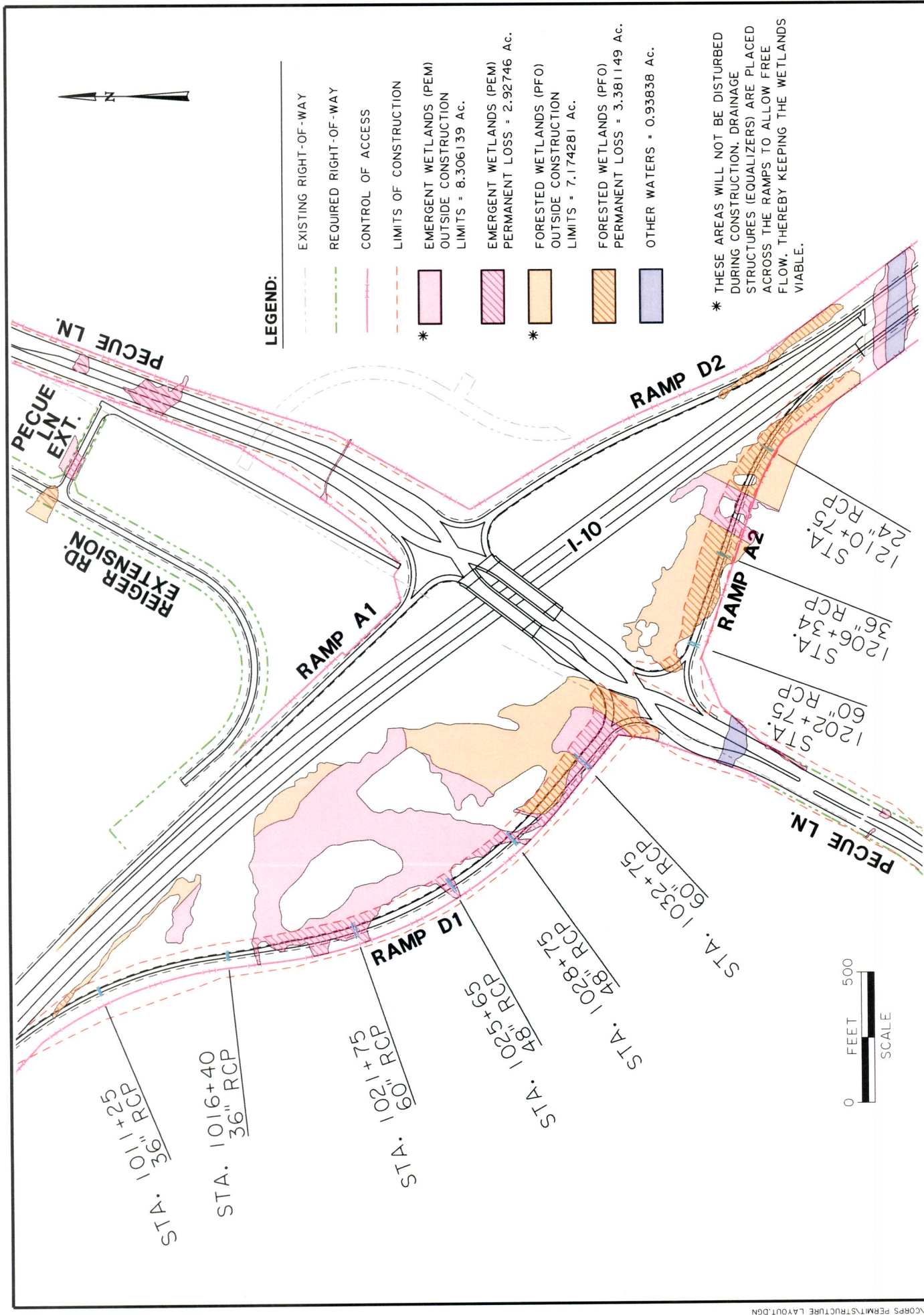

LEGEND:

- EXISTING RIGHT-OF-WAY
- REQUIRED RIGHT-OF-WAY
- CONTROL OF ACCESS
- LIMITS OF CONSTRUCTION
- * EMERGENT WETLANDS (PEM)
OUTSIDE CONSTRUCTION
LIMITS = 8,306,139 Ac.
- EMERGENT WETLANDS (PEM)
PERMANENT LOSS = 2,92746 Ac.
- * FORESTED WETLANDS (PFO)
OUTSIDE CONSTRUCTION
LIMITS = 7,174281 Ac.
- FORESTED WETLANDS (PFO)
PERMANENT LOSS = 3,381,149 Ac.
- OTHER WATERS = 0,93838 Ac.

* THESE AREAS WILL NOT BE DISTURBED DURING CONSTRUCTION. DRAINAGE STRUCTURES (EQUALIZERS) ARE PLACED ACROSS THE RAMPS TO ALLOW FREE FLOW, THEREBY KEEPING THE WETLANDS VIABLE.

US Army Corps of Engineers
New Orleans District

**PECUE LANE/I-10 INTERCHANGE
STRUCTURE LAYOUT MAP**

SHREAD-KUYRKENDALL & ASSOC., INC.

DESIGNED: _____
CHECKED: _____
DATE: _____

N.D.G. _____
R.W.M. _____
J.E.P. _____
N.D.G. _____

NO. _____
DATE _____

REVISION DESCRIPTION _____

BY _____

SHEET NUMBER _____

PARISH: EAST BATON ROUGE

FEDERAL PROJECT: H004104

STATE PROJECT: H-004104

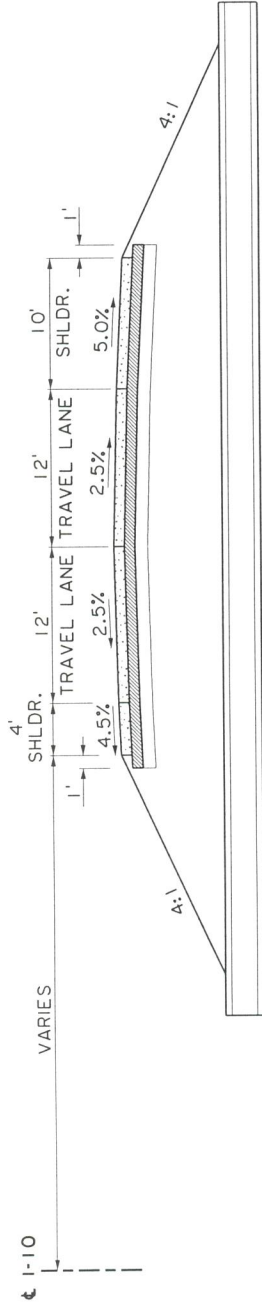

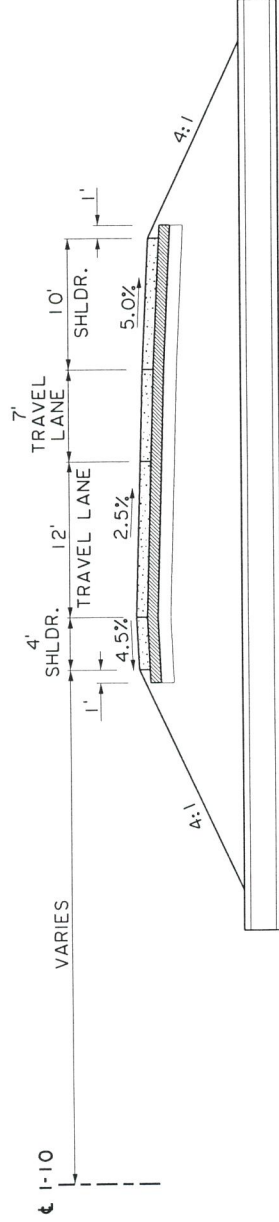

TYPICAL FINISHED SECTION - RAMP A2 (N.T.S.)
STA. 1202+75

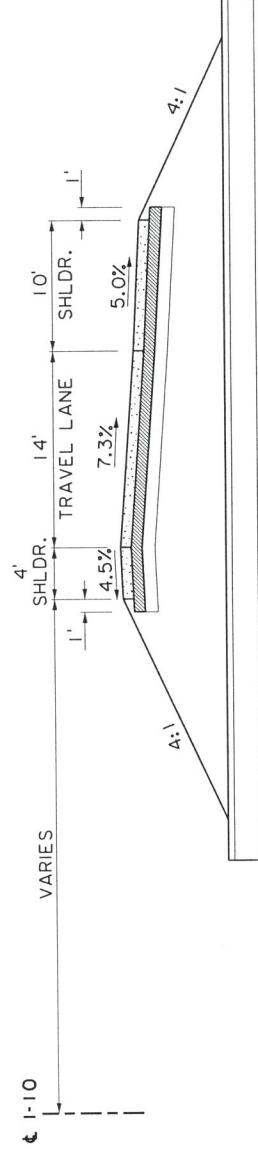

TYPICAL FINISHED SECTION - RAMP A2 (N.T.S.)
STA. 1206+34



TYPICAL FINISHED SECTION - RAMP A2 (N.T.S.)
STA. 1210+75

DESIGNED		N.D.G.	PARISH	EAST BATON ROUGE	SHEET NUMBER
CHECKED		R.W.M.	FEDERAL PROJECT	H004104	
DETAILED		J.E.P.	STATE PROJECT	H.004104	
CHECKED		N.D.G.	DATE	NOVEMBER, 2015	
NO.		DATE	REVISION DESCRIPTION	BY	
<div>  <div> US Army Corps of Engineers New Orleans District </div> </div> <div> <div> <div>PECUE LANE/I-10 INTERCHANGE</div> <div>TYPICAL SECTIONS</div> <div>RAMP A2</div> </div> <div>SHREAD-KUYRKENDALL & ASSOC., INC.</div> </div> <div>  </div>					

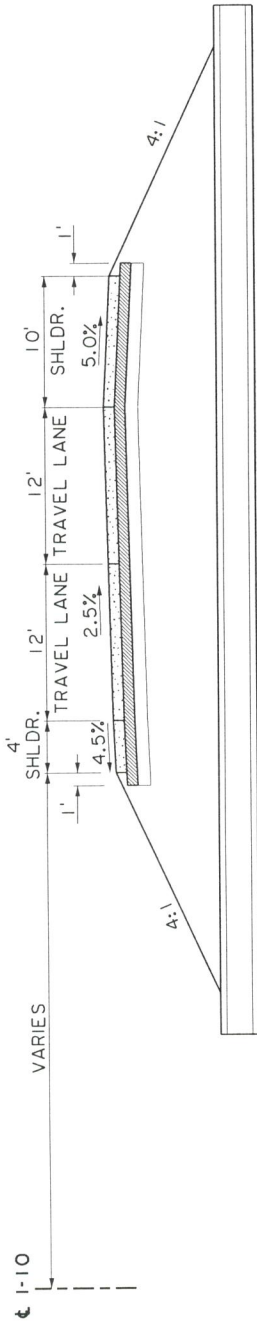

TYPICAL FINISHED SECTION - RAMP D1 (N.T.S.)
STA. 1021+75, STA. 1025+65, AND STA. 1028+75

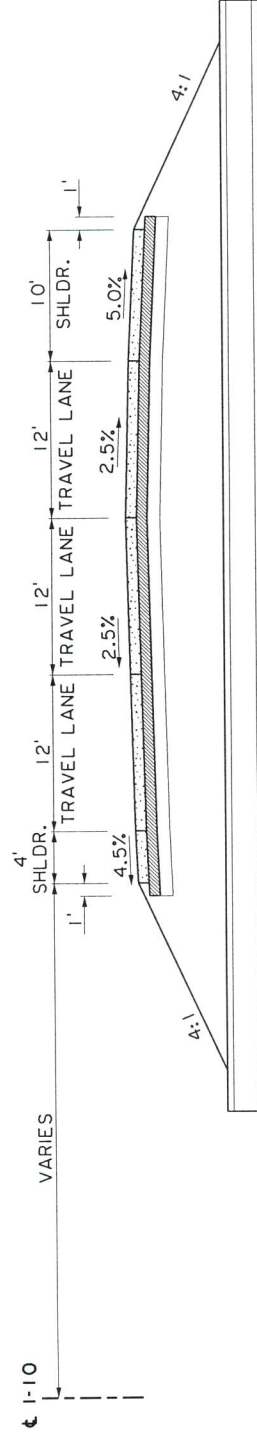

TYPICAL FINISHED SECTION - RAMP D1 (N.T.S.)
STA. 1032+75



US Army Corps
of Engineers
New Orleans District

PECUE LANE/I-10 INTERCHANGE
TYPICAL SECTIONS
RAMP D1

SHRE AD-KUYRKENDALL & ASSOC., INC.

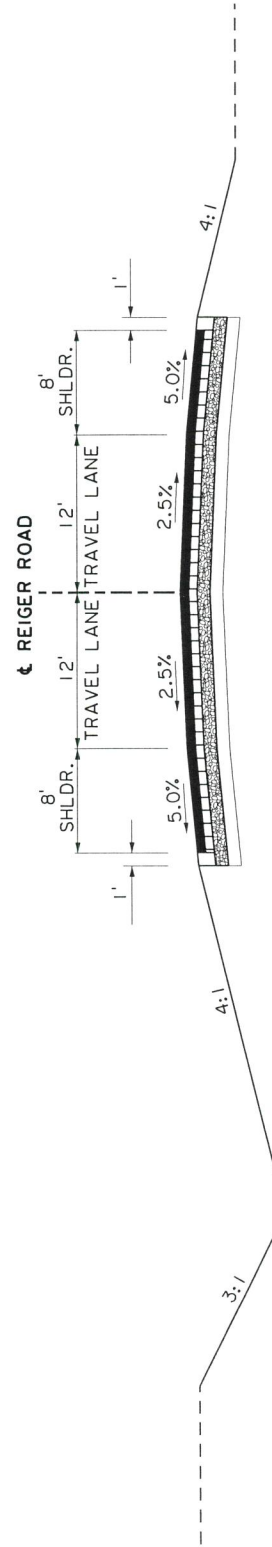
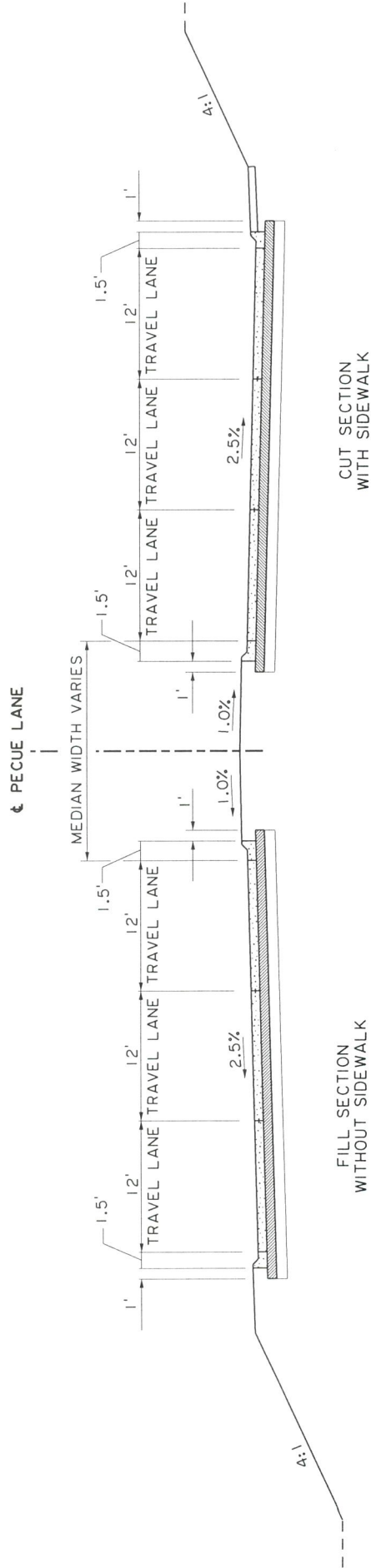

DESIGNED	CHECKED	N.D.G.	PARISH	EAST BATON ROUGE	SHEET NUMBER
DETAILED	CHECKED	J.E.P.	FEDERAL PROJECT	H004104	
DATE	NOVEMBER, 2015	NOVEMBER, 2015	STATE PROJECT	H. 004104	
NO.	DATE	REVISION DESCRIPTION	BY		

[illegible]