



REPLY TO
ATTENTION OF

DEPARTMENT OF THE ARMY
CORPS OF ENGINEERS, NEW ORLEANS DISTRICT
7400 LEAKE AVENUE
NEW ORLEANS, LOUISIANA 70118

September 5, 2017

Operations Division
Central Evaluation Section
Project Manager
S. Gail Gainey
(504) 862-1545

SUBJECT: MVN-2014-02485-CG

PUBLIC NOTICE

Interested parties are hereby notified that an application has been received by the District engineer for a Department of the Army permit to authorize the following pursuant to (X) Section 10 of the Rivers and Harbors Act of March 3, 1899 (30 Stat. 1151; 33 USC 403).

**CONSTRUCTION OF A BOATHOUSE AND DECK ON THE AMITE RIVER
IN LIVINGSTON PARISH**

NAME OF APPLICANT: Mr. Johnny Cassagne, c/o Kingfisher Construction, 11744 River Highlands Drive, St. Amant, Louisiana 70774.

LOCATION OF WORK: Along the Amite River, right descending bank, Tract A-1 at 13921 Calle Sevario Street, Canary Island Subdivision, Section 41, Township 8 South – Range 3 East, within the Lake Pontchartrain – Amite River Basin (HUC 08070202), near Port Vincent, Louisiana, in Livingston Parish, as shown on the attached drawings.

CHARACTER OF WORK: Construction of a 630 SF boathouse and 489 SF deck and walkway on the Amite River, extending a maximum of 63 linear feet into the waterway. Approximately 0.026 acre of waterbottom habitat will be impacted by the structure, as shown on the enclosed drawings.

The applicant has designed the project to avoid and minimize direct and secondary adverse impacts to the maximum extent practicable. No dredging, excavation or fill is proposed and all work will be conducted from non-jurisdictional areas or from marine equipment in the waterway to avoid unnecessary impacts.

The comment period for the Department of the Army will close **15 days** from the date of this public notice. Written comments, including suggestions for modifications or objections to the proposed work, stating reasons thereof, are being solicited from anyone having interest in this permit must be mailed so as to be received before or by the last day of the comment period. Letters concerning the Corps of Engineers permit application must reference the applicant's name and the Permit Application Number,

and be mailed to the Corps of Engineers at the address above, **ATTENTION: REGULATORY BRANCH.**

Corps of Engineers Permit Criteria

The decision whether to issue a permit will be based on an evaluation of the probable impacts, including cumulative impacts of the proposed activity on the public interest. That decision will reflect the national concern for both protection and utilization of important resources. The benefit which reasonably may be expected to accrue from the proposal must be balanced against its reasonably foreseeable detriments. All factors which may be relevant to the proposal will be considered including the cumulative effects thereof; among those are conservation, economics, aesthetics, general environmental concerns, wetlands, historic properties, fish and wildlife values, flood hazards, floodplain values, land use, navigation, shoreline erosion and accretion, recreation, water supply and conservation, water quality, energy needs, safety, food and fiber production, mineral needs, considerations of property ownership and, in general, the needs and welfare of the people.

The U.S. Army Corps of Engineers is soliciting comments from the public, federal, state, and local agencies and officials, Indian Tribes, and other interested parties in order to consider and evaluate the impacts of this proposed activity. Any comments received will be considered by the U.S. Army Corps of Engineers to determine whether to make, modify, condition, or deny a permit for this proposal. To make this decision, comments are used to assess impacts on endangered species, historic properties, water quality, general environmental effects, and other public interest factors listed above. Comments are used in the preparation of an Environmental Assessment and/or an Environmental Impact Statement pursuant to the National Environmental Policy Act. Comments are also used to determine the need for a public hearing and to determine the overall public interest of the proposed activity.

The New Orleans District is unaware of properties listed on the National Register of Historic Places near the proposed work. The possibility exists that the proposed work may damage or destroy presently unknown archeological, scientific, pre-historical, historical sites, or data. Copies of this notice are being sent to the State Archeologist and the State Historic Preservation Officer.

Our initial finding is that the proposed work would neither affect any species listed as endangered by the U.S. Departments of Interior or Commerce, nor affect any habitat designated as critical to the survival and recovery of any endangered species. The New Orleans District has determined that the proposed project is located in waters known to be utilized by the West Indian Manatee (*Trichechus manatus*). Utilizing Standard Local Operating Procedure for Endangered Species in Louisiana (SLOPES), dated October 22, 2014, between the U.S. Army Corps of Engineers, New Orleans and U.S. Fish and Wildlife Service, Ecological Services Office, the Corps has determined that with the

inclusion of the Standard Manatee Conditions for In-Water Activities, proposed work is not likely to adversely affect the West Indian Manatee.

This notice initiates the Essential Fish Habitat (EFH) consultation requirements of the Magnuson-Stevens Fishery Conservation and Management Act. The applicant's proposal would result in the destruction or alteration of 0.026 acres of EFH utilized by various life stages of red drum and penaeid shrimp. Our initial determination is that the proposed action would not have a substantial adverse impact on EFH or federally managed fisheries in the Gulf of Mexico. Our final determination relative to project impacts and the need for mitigation measures is subject to review by and coordination with the National Marine Fisheries Service.

If the proposed work involves deposits of dredged or fill material into navigable waters, the evaluation of the probable impacts will include the application of guidelines established by the Administrator of the Environmental Protection Agency. Also, a certification that the proposed activity will not violate applicable water quality standards will be required from the Department of Environmental Quality, Office of Environmental Services, before a permit is issued.

Any person may request, in writing, within the comment period specified in this notice, that a public hearing be held to consider this application. Requests for public hearings shall state, with particularity, the reasons for holding a public hearing.

The applicant has certified that the proposed activity described in the application complies with and will be conducted in a manner that is consistent with the Louisiana Coastal Resources Program (Louisiana Coastal Zone Application P20170598). The Department of the Army permit will not be issued unless the applicant received approval or a waiver of the Coastal Use Permit by the Department of Natural Resources.

You are requested to communicate the information contained in this notice to any other parties whom you deem likely to have interest in the matter.

JOHN M. HERMAN
Chief, Central Evaluation Section
Regulatory Branch

Enclosures

Vicinity Map



*Johnny Cassagne
 13921 Calle Sevario St.
 Port Vincent, Livingston Parish
 70726
 Construct a boat house*

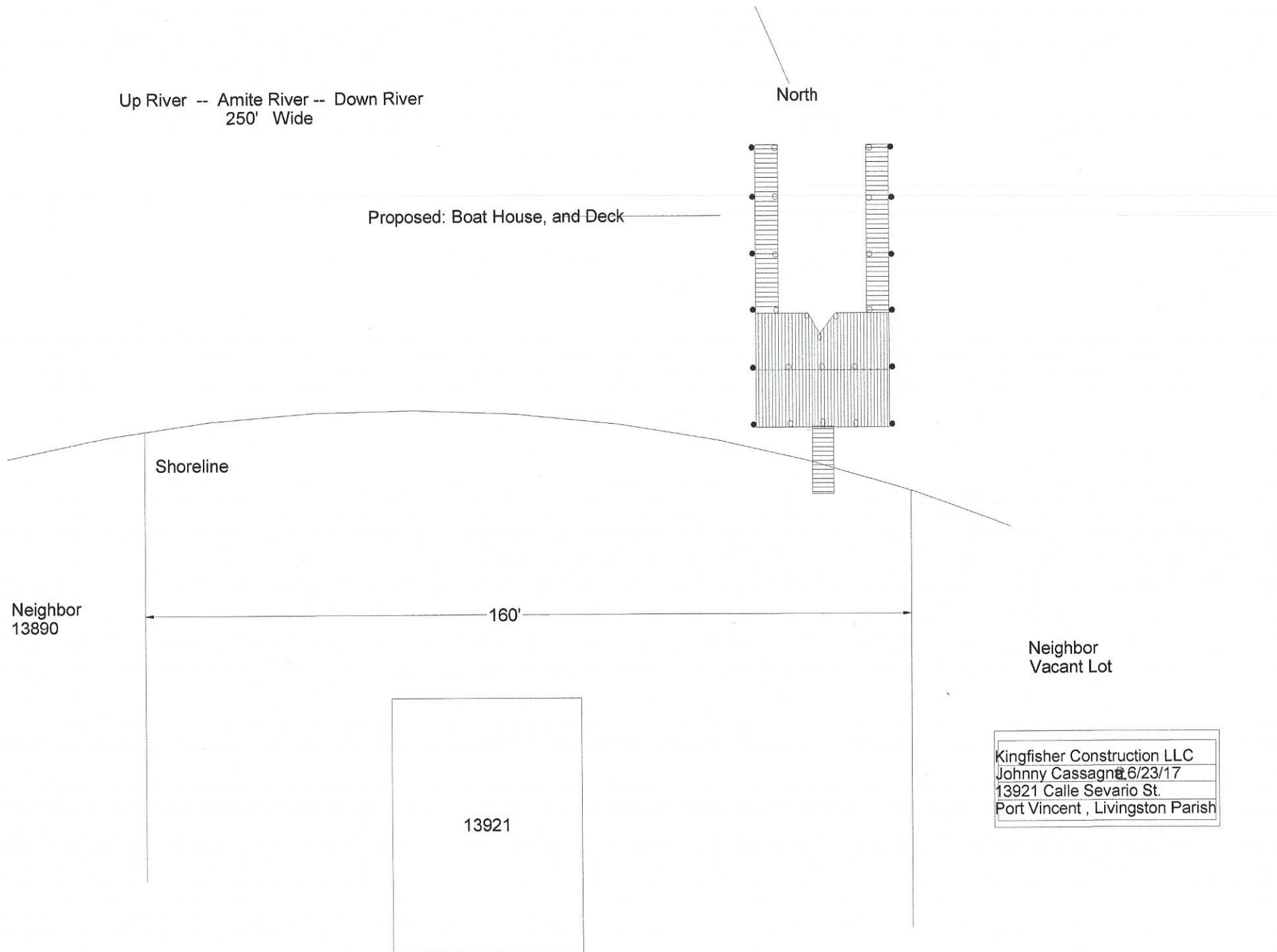

Up River -- Amite River -- Down River
250' to opposite bank

All treated wood materials

No Dredging or
Fill Required

Boat House and Deck

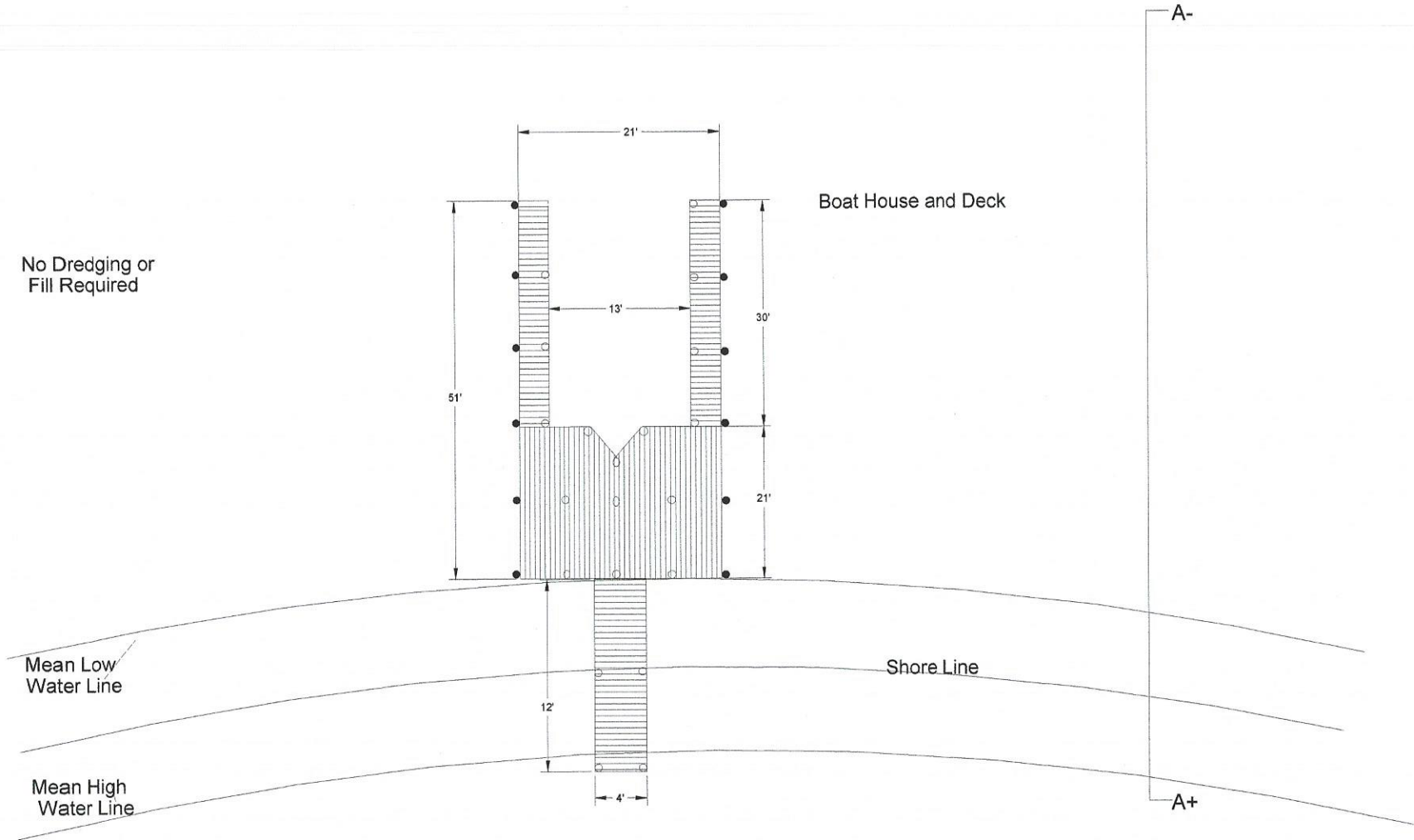

Kingfisher Construction LLC
Johnny Cassagna 6/23/17
13921 Calle Sevario St.
Port Vincent, Livingston Parish

Cross Section

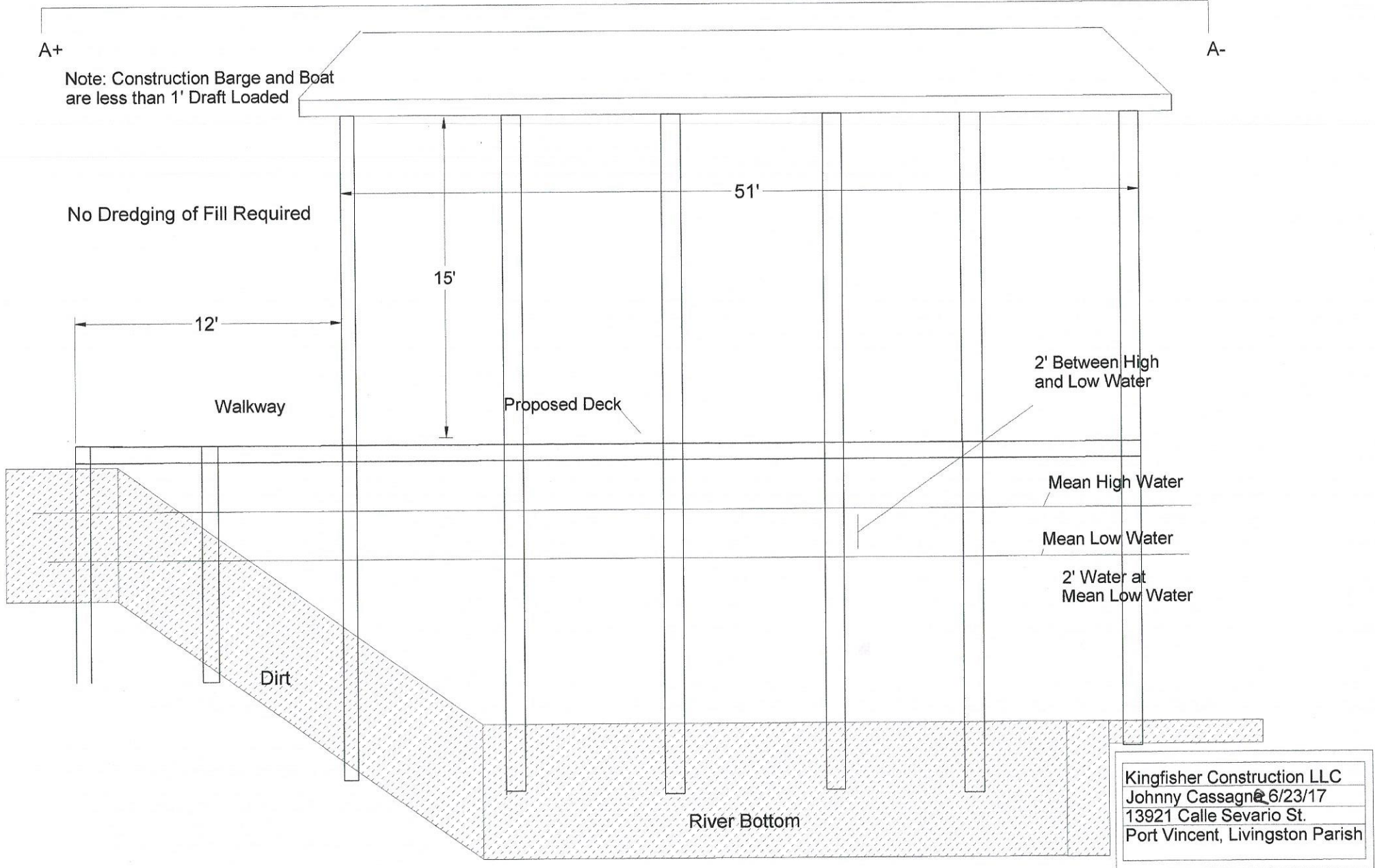

Kingfisher Construction LLC
Johnny Cassagne 6/23/17
13921 Calle Sevario St.
Port Vincent, Livingston Parish

Permit Plat Notes

1. As built drawings and/or plats shall have written on them the date of completion of said activities and shall be submitted to the Louisiana Department of Natural Resources, Office of Coastal Management, P.O. Box 44487, Baton Rouge, La 70804-4487 within 30 days following project completion.
2. All structures built under the authorization and conditions of this permit shall be removed from the site within 120 days of abandonment of the facilities for the herein permitted use, or when these structures fall into state of disrepair such that they can no longer function as intended. This condition does not preclude the necessity for revising the current permit or obtaining a separate Coastal Use Permit, should one be required, for such removal activities.
3. Structures must also be marked/lighted in accordance with U.S. Coast Guard regulations.
4. In order to ensure the safety of all parties, the permittee shall contact the Louisiana One Call System (1-800-272-3020) a minimum of 48 hours prior to the commencement of any excavation (digging, dredging, jetting, etc.) or demolition activity.
5. The area where the project is located is all part of the aboriginal homelands of the Chitimacha Tribe of Louisiana. As such, large villages, burial sites, and sacred sites were in place in that entire area. If at any time during the course of the work, any traditional cultural properties are discovered, Permittee shall immediately contact Kimberly S. Walden (Cultural Director) or Melanie Aymond (Research Coordinator) at (337) 923 - 9923 or (337) 923 - 4395. Office hours are Monday thru Friday between 7:30 A.M. - 11:30 A.M. If Traditional Cultural properties are discovered on the weekend or after business hours, the notification shall be made the next business morning.

Kingfisher Construction LLC
Johnny Cassagna 6/23/17
13921 Calle Sevario St.
Port Vincent, Livingston Parish