



REPLY TO
ATTENTION OF:

DEPARTMENT OF THE ARMY
CORPS OF ENGINEERS, NEW ORLEANS DISTRICT
7400 LEAKE AVENUE
NEW ORLEANS, LOUISIANA 70118

June 19, 2017

Operations Division
Central Evaluation Section

Project Manager
Dirreen Arnold
(504) 862-2301
Dirreen.S.Arnold@usace.army.mil

SUBJECT: MVN 2009-01624 CA

PUBLIC NOTICE

Interested parties are hereby notified that a permit application has been received by the New Orleans District of the US Army Corps of Engineers pursuant to: [X] Section 10 of the Rivers and Harbors Act of March 3, 1899 (30 Stat. 1151; 33 USC 403).

SOUTH TIMBALIER 154 ARTIFICIAL REEF ENHANCEMENT
GRAND ISLE 94 "B" JACKET, GULF OF MEXICO

NAME OF APPLICANT: LOUISIANA DEPARTMENT OF WILDLIFE AND FISHERIES,
Attn: Artificial Reef Coordinator, Michael McDonough, Post Office Box 98000, Baton Rouge, Louisiana 70808.

LOCATION OF WORK: Gulf of Mexico, Block 154, South Timbalier Area, approximately 31 nautical miles southwest of Fourchon, Louisiana, off the coast of Lafourche Parish, Louisiana, as shown on the enclosed drawings.

CHARACTER OF WORK: The applicant has requested Department of the Army authorization to deploy Fieldwood Energy's Grand Isle 94 "B" Jacket in the South Timbalier 154 Artificial Reef Site to provide structural habitat for the purpose of enhancing fishing opportunities off the coast of Louisiana. The reef site is located more than 2 nautical miles from any safety fairway and the charted clearance of 120 feet at the reef site will be maintained. No special aquatic sites will be affected by this project and no mitigation is anticipated. This request is pursuant to Act 100, 1986 Louisiana Legislature and National Fishing Enhancement Act of 1984.

The comment period for the Department of the Army Permit will close **15 days** from the date of this public notice. Written comments, including suggestions for modifications or objections to the proposed work, stating reasons thereof, are being solicited from anyone having interest in this permit must be mailed so as to be received before or by the last day of the comment period. Letters concerning the Corps of

Engineers permit application must reference the applicant's name and the Permit Application Number, and be mailed to the Corps of Engineers at the address above, **ATTENTION: REGULATORY BRANCH**. Individuals or parties may request an extension of time in which to comment on the proposed work by writing or e-mailing the Corps of Engineers Project Manager listed above. Any request must be specific and substantively supportive of the requested extension, and received by this office prior to the end of the initial comment period. The Section Chief will review the request and the requestor will be promptly notified of the decision to grant or deny the request. If granted, the time extension will be continuous to the initial comment period and, inclusive of the initial comment period, will not exceed a total of 30 calendar days.

Corps of Engineers Permit Criteria

The decision as to whether a permit will be issued will be based on an evaluation of the impact of the proposed work on navigation and national security.

The U.S. Army Corps of Engineers is soliciting comments from the public, federal, state, and local agencies and officials, Indian Tribes, and other interested parties in order to consider and evaluate the impacts of this proposed activity. Any comments received will be considered by the U.S. Army Corps of Engineers to determine whether to make, modify, condition, or deny a permit for this proposal. To make this decision, comments are used to assess impacts on endangered species, historic properties, water quality, general environmental effects, and other public interest factors listed above. Comments are used in the preparation of an Environmental Assessment and/or an Environmental Impact Statement pursuant to the National Environmental Policy Act. Comments are also used to determine the need for a public hearing and to determine the overall public interest of the proposed activity.

The New Orleans District is unaware of properties listed on the National Register of Historic Places near the proposed work. The possibility exists that the proposed work may damage or destroy presently unknown archeological, scientific, pre-historical, historical sites, or data. Issuance of this public notice solicits input from the State Archeologist and State Historic Preservation Officer regarding potential impacts to cultural resources.

Our initial finding is that the proposed work would not affect any species, nor affect any habitat designated as critical to the survival and recovery of such species, listed as endangered by the U.S. Department of Commerce.

This notice initiates the Essential Fish Habitat (EFH) consultation requirements of the Magnuson-Stevens Fishery Conservation and Management Act. The applicant's proposal may result in the destruction or alteration of 0 acres of EFH utilized by

various life stages of red drum and penaeid shrimp. Our initial determination is that the proposed action would not have a substantial adverse impact on EFH or federally managed fisheries in the Gulf of Mexico. Our final determination relative to project impacts and the need for mitigation measures is subject to review by and coordination with the National Marine Fisheries Service.

If the proposed work involves deposits of dredged or fill material into navigable waters, the evaluation of the probable impacts will include the application of guidelines established by the Administrator of the Environmental Protection Agency. Also, a certification that the proposed activity will not violate applicable water quality standards will be required from the Department of Environmental Quality, before a permit is issued.

Any person may request, in writing, within the comment period specified in this notice, that a public hearing be held to consider this application. Requests for public hearings shall state, with particularity, the reasons for holding a public hearing.

You are requested to communicate the information contained in this notice to any other parties whom you deem likely to have interest in the matter.

The applicant has certified that the proposed activity described in the application complies with and will be conducted in a manner that is consistent with the Louisiana Coastal Resources Program. The Department of the Army permit will not be issued unless the applicant received approval or a waiver of the Coastal Use Permit by the Department of Natural Resources.



JOHN M. HERMAN
Chief, Central Evaluation Section
Regulatory Branch

Enclosure

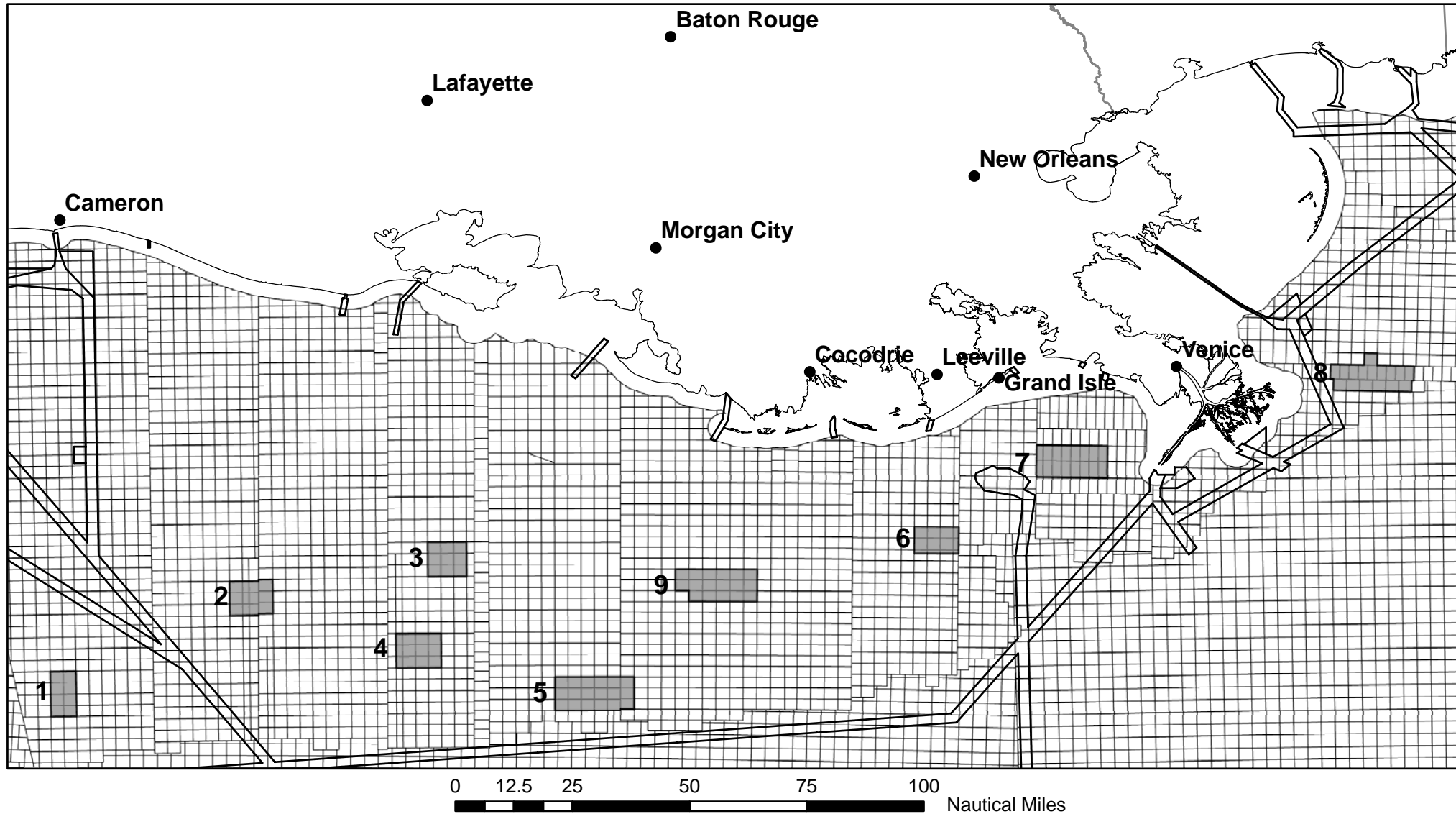
Louisiana Artificial Reef Planning Areas



Planning Areas

-  **Planning Areas**
-  **Fairways**
-  **OCS Blocks**

- | | |
|---|----------------------------------|
| 1. West Cameron Planning Area | 6. South Timbalier Planning Area |
| 2. East Cameron Planning Area | 7. West Delta Planning Area |
| 3. South Marsh Island (76) Planning Area | 8. Main Pass Planning Area |
| 4. South Marsh Island (146) Planning Area | 9. Ship Shoal Planning Area |
| 5. Eugene Island Planning Area | |



Louisiana Artificial Reef Program

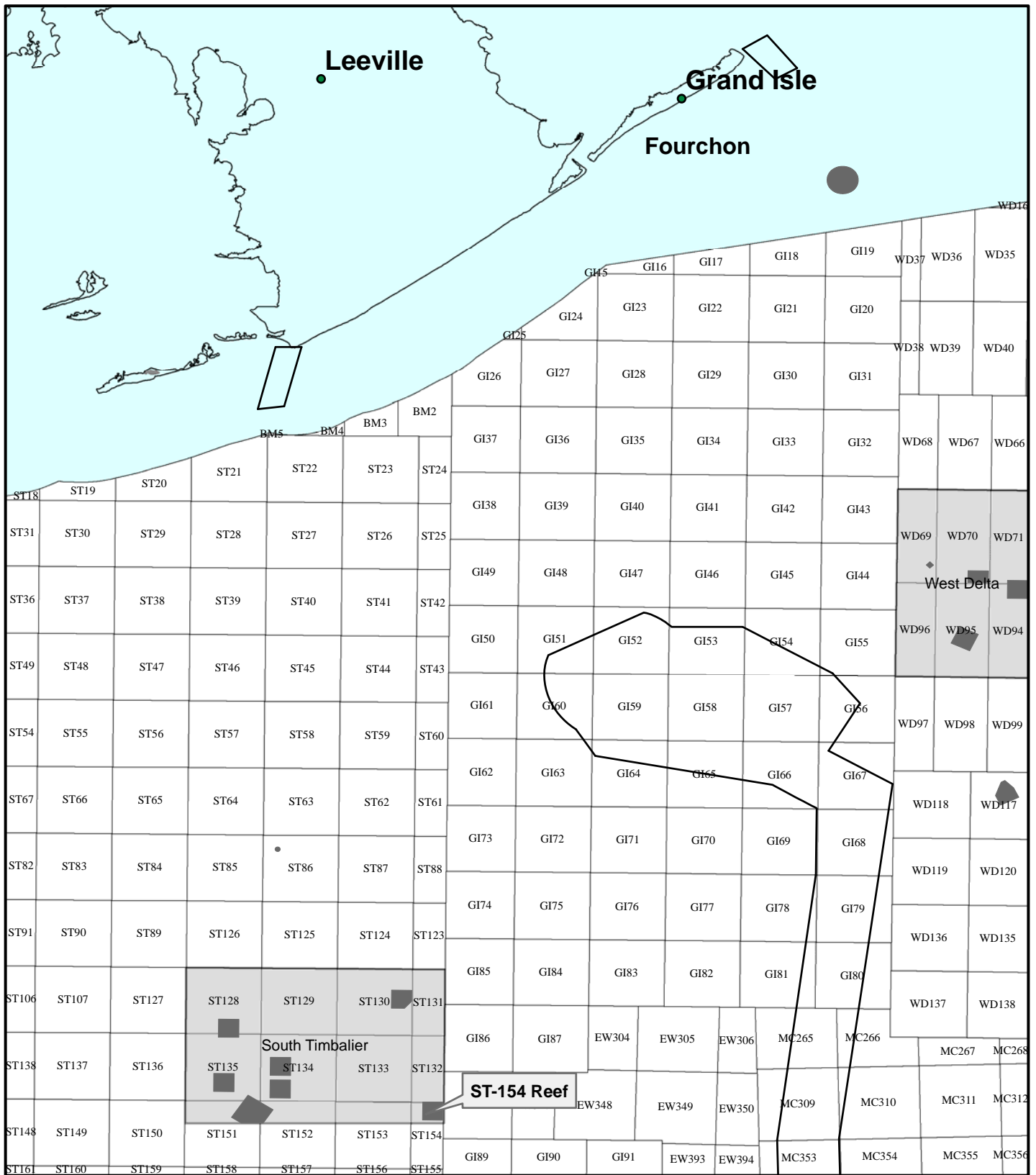

- Planning Area
- Permitted Reef Sites
- Fairways
- OCS Blocks



ST132

1

2

4

3

ST154
OCS-G-35250
Apache

GI88

GI94-B Jacket
in Proposed Reef Position
(Orientation filed determined)

NAD27 Louisiana South Feet
X: 2,383,202.17
Y: -15,822.68
Lat: 28°37'03.6076"N
Lon: 90°08'21.3247"W

NAD83 Louisiana South Feet
X: 3,664,004.81
Y: 44,880.65
Lat: 28°37'04.4840"N
Lon: 90°08'21.5752"W

ST170 F

ST154 REEF

GI86 AA
MC486 A Top
GI90 A
GI93 C
GI102 A
ST179 B
GI94 B
R300'

500' OFFSET

GRID NORTH

NOTES

1. THIS PLAT WAS PREPARED FOR PERMIT PURPOSES ONLY, AND IS NOT A PROPERTY BOUNDARY SURVEY, AND AS SUCH DOES NOT COMPLY WITH THE "STANDARDS OF PRACTICE FOR BOUNDARY SURVEYS" AS ADOPTED BY THE LOUISIANA PROFESSIONAL ENGINEERING AND LAND SURVEYING BOARD.

ARTIFICIAL REEF AREA

Tie	X Coordinate	Y Coordinate	Latitude	Longitude
1	2,381,227.73	-13,250.40	28°37'29.2722"N	90°08'43.1727"W
2	2,385,227.73	-13,250.40	28°37'28.8595"N	90°07'58.3018"W
3	2,385,227.73	-17,250.40	28°36'49.2661"N	90°07'58.7718"W
4	2,381,227.73	-17,250.40	28°36'49.6787"N	90°08'43.6379"W



FIELDWOOD ENERGY

GRAND ISLE 94 "B"
PROPOSED REEF POSITION
BLOCK 154
SOUTH TIMBALIER AREA
GULF OF MEXICO

Geodetic Datum: NAD27
Projection: LOUISIANA SOUTH
Grid Units: US SURVEY FEET

SCALE 1:12000
0 1000
FEET



FUGRO USA MARINE, INC.
200 Dulles Drive
Lafayette, Louisiana 70506
(337) 237-1300

Job No.: 17170160 Date: 5/16/2017 Drwn: BCN Chart: 1 Of: 3
DWG File: H:\2017\17170160\DS\GIS\...\ST154_GI94-B_REEF_PROPOS...

5/16/2017

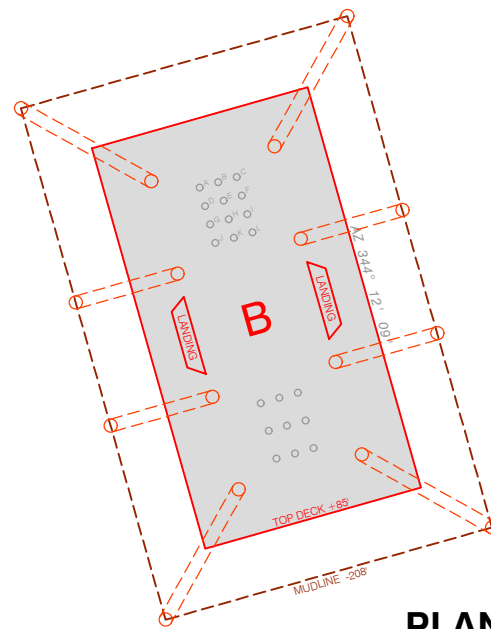
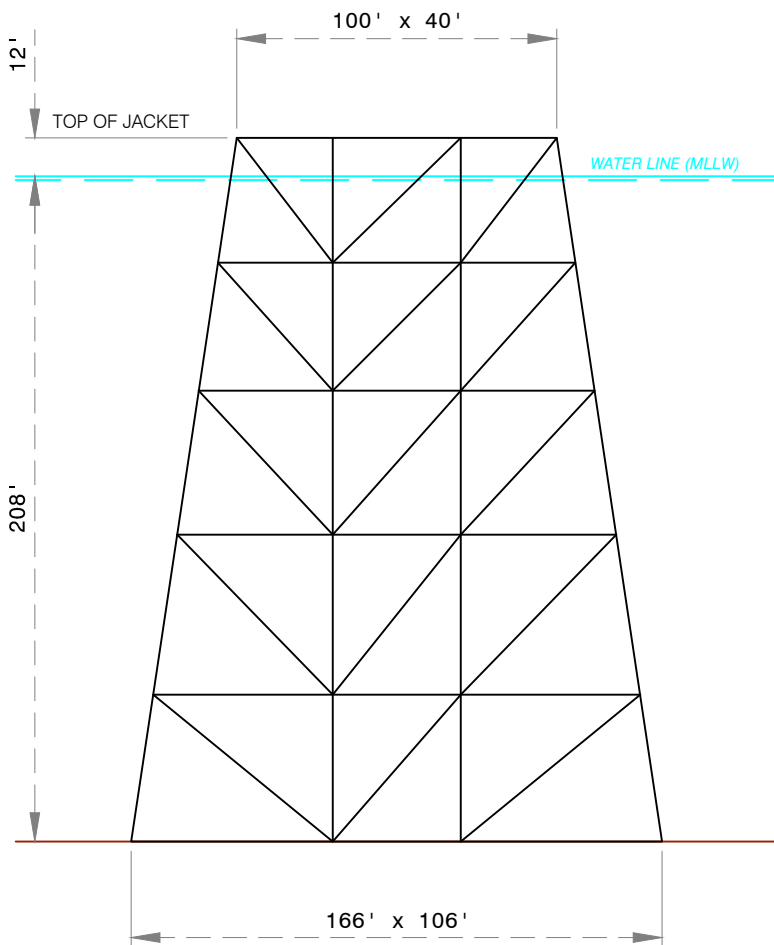

PLAN

PROFILE



GRAND ISLE 94 "B"
TO BE REEFED
 BLOCK 154
 SOUTH TIMBALIER AREA
 GULF OF MEXICO

Geodetic Datum: NAD27
 Projection: LOUISIANA SOUTH
 Grid Units: US SURVEY FEET

SCALE 0 60'
 FEET



FUGRO USA MARINE, INC.
 200 Dulles Drive
 Lafayette, Louisiana 70506
 (337) 237-1300

Job No.: 17170160	Date: 5/16/2017	Drwn: BCN	Chart: 2 Of: 3
DWG File: H:\2017\17170160\DS\GIS\...\ST154_GI94-B_REEF_PROPOS...			

5/16/2017

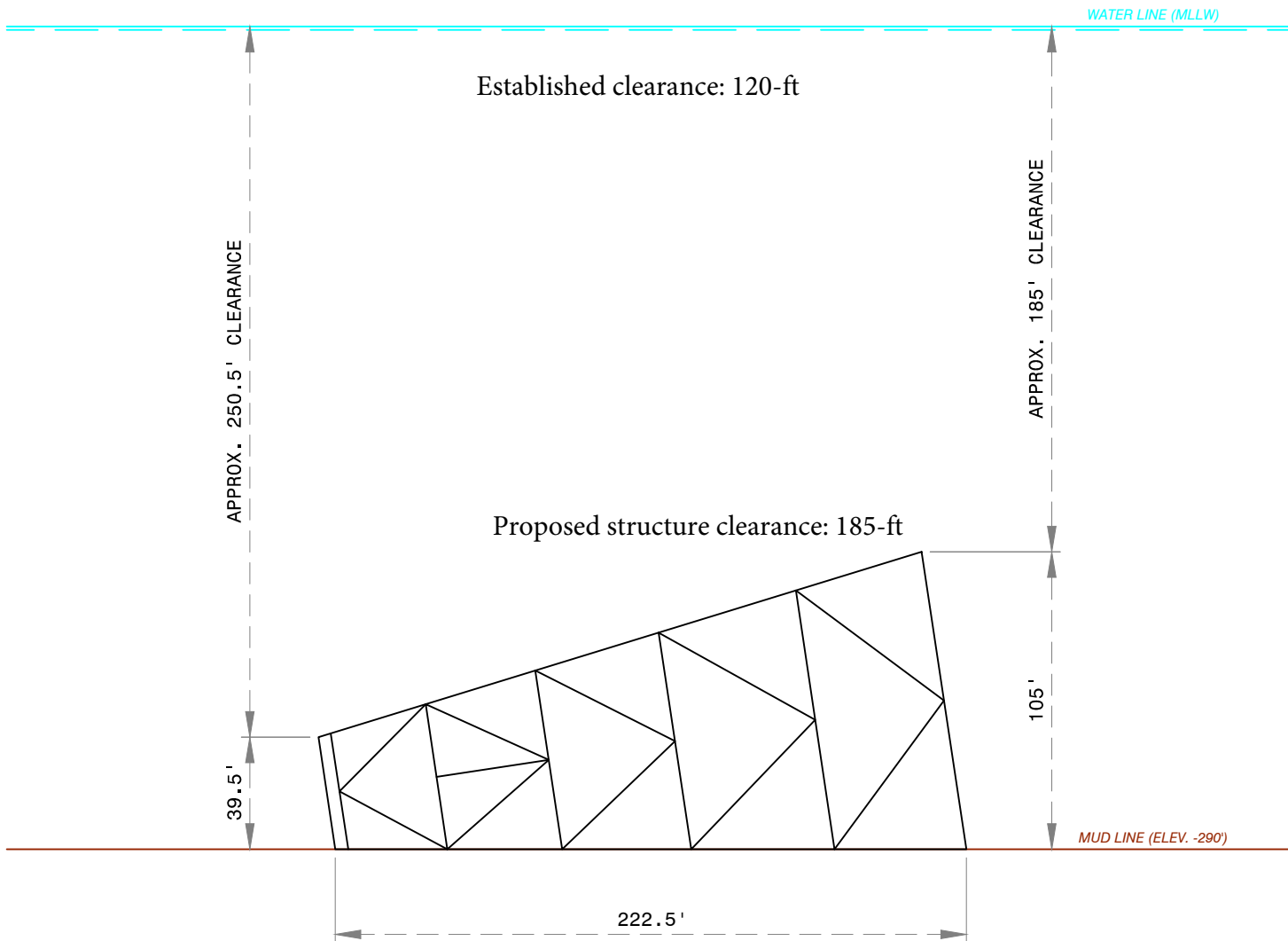

PROFILE

NOTES

1. THIS PLAT WAS PREPARED FOR PERMIT PURPOSES ONLY, AND IS NOT A PROPERTY BOUNDARY SURVEY, AND AS SUCH DOES NOT COMPLY WITH THE "STANDARDS OF PRACTICE FOR BOUNDARY SURVEYS" AS ADOPTED BY THE LOUISIANA PROFESSIONAL ENGINEERING AND LAND SURVEYING BOARD.
2. 12.83 MILES TO NEAREST SHIPPING FAIRWAY.
3. CLEARANCES BASED ON CONSTRUCTION DRAWINGS.



GRAND ISLE 94 "B" PROPOSED REEF POSITION BLOCK 154 SOUTH TIMBALIER AREA GULF OF MEXICO

Geodetic Datum: NAD27
Projection: LOUISIANA SOUTH
Grid Units: US SURVEY FEET

SCALE 0 60'
FEET



FUGRO USA MARINE, INC.
200 Dulles Drive
Lafayette, Louisiana 70506
(337) 237-1300

Job No.: 17170160

Date: 5/16/2017

Drwn: BCN

Chart:

Of: 3

DWG File: H:\2017\17170160\DS\GIS\...\ST154_GI94-B_REEF_PROPOS...

5/16/2017