



DEPARTMENT OF THE ARMY
CORPS OF ENGINEERS, NEW ORLEANS DISTRICT
7400 LEAKE AVENUE
NEW ORLEANS, LOUISIANA 70118

May 22, 2017

REPLY TO
ATTENTION OF:

Operations Division
Western Evaluation Section
Project Manager
Darlene Herman
(504) 862-2287
Darlene.C.Herman@usace.army.mil

SUBJECT: MVN 2007-0710 WB

PUBLIC NOTICE

Interested parties are hereby notified that an application has been received by the District engineer for a Department of the Army permit to authorize the following pursuant to (X) Section 10 of the Rivers and Harbors Act of March 3, 1899 (30 Stat. 1151; 33 USC 403); and/or () Section 404 of the Clean Water Act (86 Stat. 816; 33 USC 1344).

MAINTENANCE DREDGING IN CALCASIEU RIVER

NAME OF APPLICANT: CITGO PIPELINE COMPANY, c/o Lanier & Associates Consulting Engineers, Inc., 4101 Magazine Street, New Orleans, Louisiana 70115

LOCATION OF WORK: In the Calcasieu River, right descending bank located approximately 30.6 miles above the mouth of the waterway in Lake Charles, Louisiana in Calcasieu Parish, as shown on the attached drawings.

CHARACTER OF WORK: Request a time extension to continue maintenance dredging operations within an area as necessary to provide adequate depths for marine vessel access. The dredging operation will occur within an area 1,925 feet long by 210 feet wide and situated approximately parallel to the existing shoreline, the outer edge to extend approximately 450 feet channelward, therefrom. Excavation activities would result in the removal of approximately 21,500 cubic yards of accumulated channel bottom material. The proposed material is to be placed at Citgo's disposal non-wet area.

The comment period for the Department of the Army Permit will close [15 days](#) from the date of this joint public notice. Written comments, including suggestions for modifications or objections to the proposed work, stating reasons thereof, are being solicited from anyone having interest in this permit and must be submitted so as to be received before or by the last day of the comment period. Letters concerning the Corps of Engineers permit application must reference the applicant's name and the Permit Application Number, and be forwarded to the Corps of Engineers at the address above, **ATTENTION: REGULATORY BRANCH.**

The decision whether to issue a permit will be based on an evaluation of the probable impact including cumulative impacts of the proposed activity on the public interest. That decision will reflect the national concern for both protection and utilization of important resources. The benefit which reasonably may be expected to accrue from the proposal must be balanced against its reasonably foreseeable detriments. All factors which may be relevant to the proposal will be considered including the cumulative effects thereof; among those are conservation, economics, aesthetics, general environmental concerns, wetlands, historic properties, fish and wildlife values, flood hazards, floodplain values, land use, navigation, shoreline erosion and accretion, recreation, water supply and conservation, water quality, energy needs, safety, food and fiber production, mineral needs, consideration of property ownership and, in general, the needs and welfare of the people.

The Corps of Engineers is soliciting comments from the public; federal, state, and local agencies and officials; Indian Tribes; and other interested parties in order to consider and evaluate the impacts of this proposed activity. Any comments received will be considered by the Corps of Engineers to determine whether to issue, modify, condition or deny a permit for this proposal. To make this decision, comments are used to assess impacts on endangered species, historic properties, water quality, general environmental effects, and the other public interest factors listed above. Comments are used in the preparation of an Environmental Assessment and/or Environmental Impact Statement pursuant to the National Environmental Policy Act. Comments are also used to determine the need for a public hearing and to determine the overall public interest of the proposed activity.

The New Orleans District is unaware of properties listed on the National Register of Historic Places near the proposed work. The possibility exists that the proposed work may damage or destroy presently unknown archeological, scientific, prehistorical, historical sites, or data. Copies of this notice is being forward to the State Archeologist and State Historic Preservation Officer regarding potential impacts to cultural resources.

Our initial finding is that the proposed work would neither affect any species listed as endangered by the U.S. Department of Interior nor affect any habitat designated as critical to the survival and recovery of any endangered species.

This notice initiates the Essential Fish Habitat (EFH) consultation requirements of the Magnus-Stevens Fishery Conservation and Management Act. The applicant's proposal would result in the destruction or alteration of 0.6 acre(s) of EFH utilized by various life stages of red drum and penaeid shrimp. Our initial determination is that the proposed action would not have a substantial adverse impact on EFH or federally managed fisheries in the Gulf of Mexico. Our final determination relative to project impacts and the need for mitigation measures is subject to review by and coordination with the National Marine Fisheries Service.

If the proposed work involves deposits of dredged or fill material into navigable waters, the evaluation of the probable impacts will include the application of guidelines established by the Administrator of the Environmental Protection Agency and certification that the proposed activity will not violate applicable water quality standards will be required from the Louisiana Department of Environmental Quality, Office of Environmental Services, before a permit is issued.

Any person may request, in writing, within the comment period specified in this notice, that a public hearing be held to consider this application. Requests for public hearings shall state, with particularity, the reasons for holding a public hearing.

You are requested to communicate the information contained in this notice to any other parties whom you deem likely to have interest in the matter.

The applicant has certified that the proposed activity described in the application complies with and will be conducted in a manner that is consistent with the Louisiana Coastal Resources Program. The Department of the Army permit will not be issued unless the applicant received approval or a waiver of the Coastal Use Permit by the Department of Natural Resources.

Darrell S. Barbara
Chief, Western Evaluation Section
Regulatory Branch

Attachments

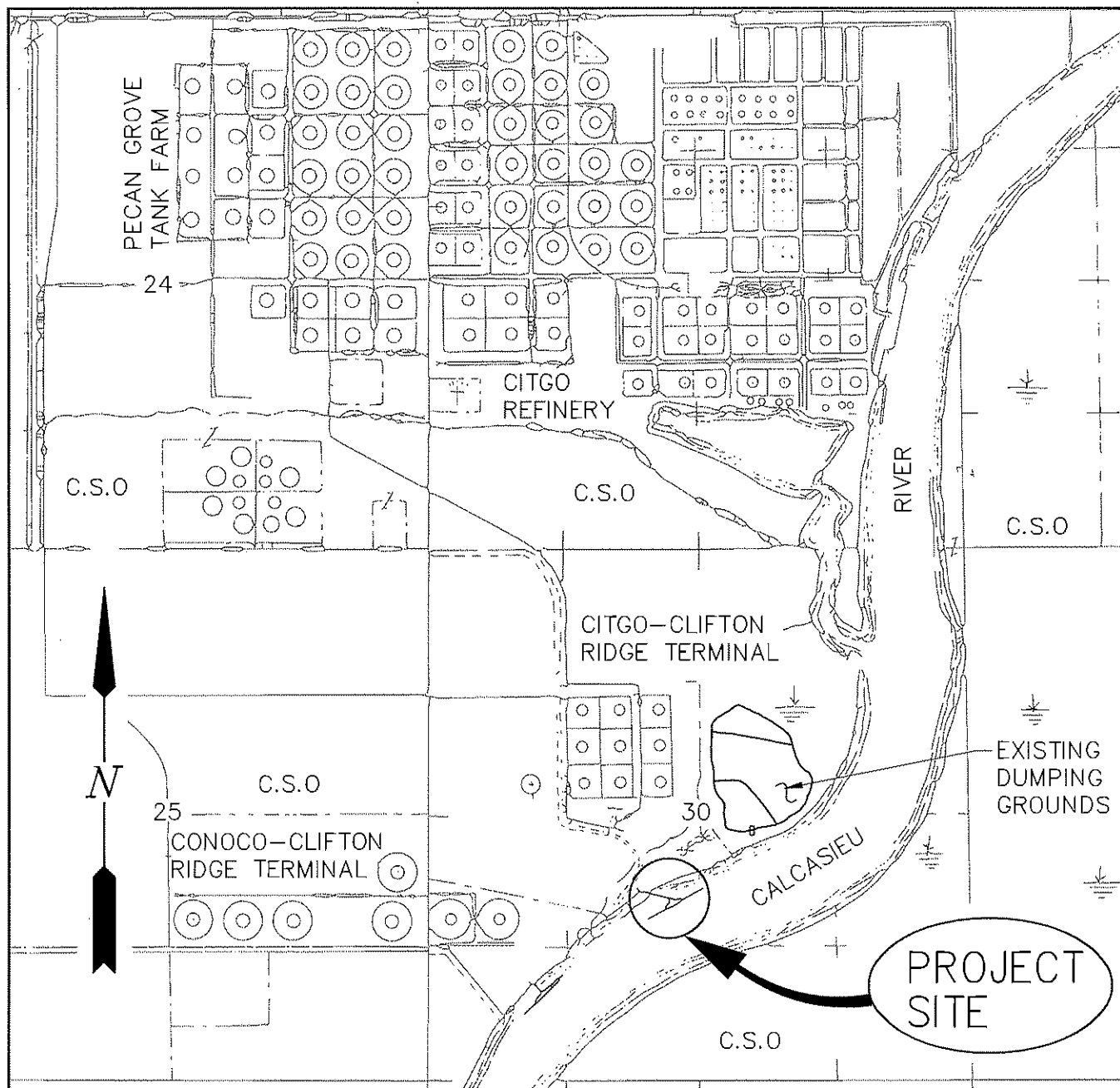

VICINITY MAP

SCALE: 1" = 1600'

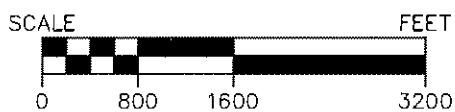

7525-P01



LANIER & ASSOCIATES
CONSULTING ENGINEERS
INCORPORATED

NEW ORLEANS, LA

HOUSTON, TX

SULPHUR

CITGO PIPELINE COMPANY

LOUISIANA

CLIFTON RIDGE TERMINAL
PROPOSED NEW MAINTENANCE DREDGING
VICINITY MAP

DATE FEB '07
DESIGN MAY
DRAWN CAP
CHECK MAY
CONTRACT 7525
SHEET No.
1 OF 4

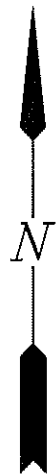

CLIFTON RIDGE
TANK FARM

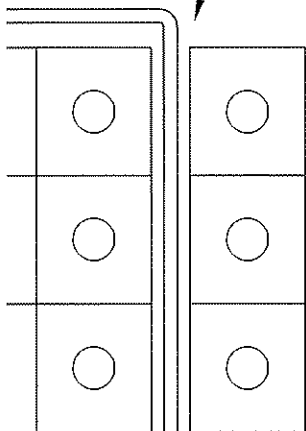

EXISTING
DUMPING
GROUNDS

EXISTING
LEVEES

CALCASIEU RIVER

OUTLET
STRUCTURE

EXISTING
CITGO DOCKS

AREA SITE PLAN

SCALE: 1" = 500'

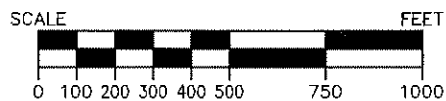

7525-P02



LANIER & ASSOCIATES
CONSULTING ENGINEERS
INCORPORATED

NEW ORLEANS, LA

HOUSTON, TX

SULPHUR

CITGO PIPELINE COMPANY

LOUISIANA

CLIFTON RIDGE TERMINAL
PROPOSED NEW MAINTENANCE DREDGING
AREA SITE PLAN

DATE FEB '07
DESIGN MAY
DRAWN CAP
CHECK MAY
CONTRACT 7525
SHEET No.

2 OF 4

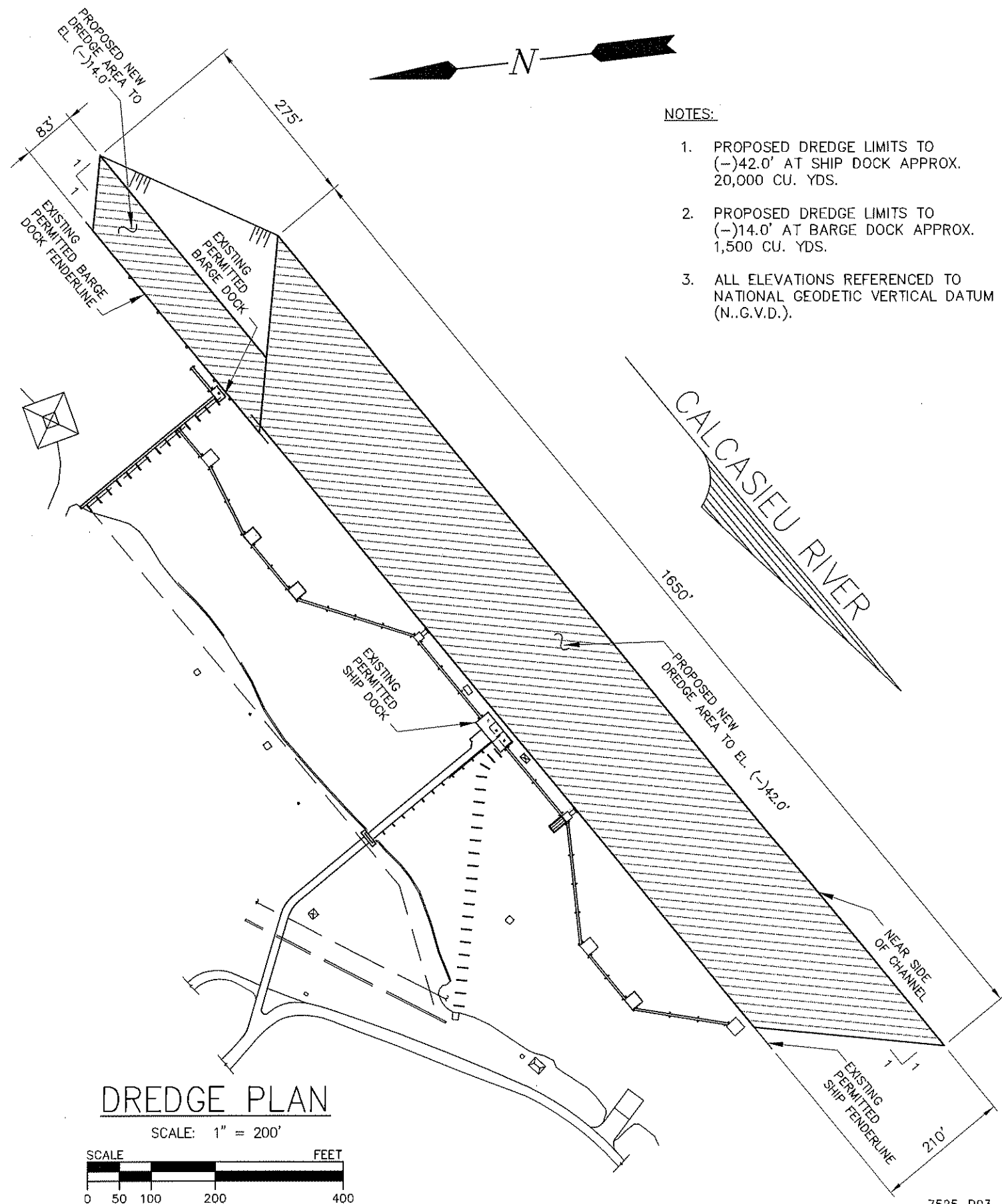

NOTES:

1. PROPOSED DREDGE LIMITS TO (-)42.0' AT SHIP DOCK APPROX. 20,000 CU. YDS.
2. PROPOSED DREDGE LIMITS TO (-)14.0' AT BARGE DOCK APPROX. 1,500 CU. YDS.
3. ALL ELEVATIONS REFERENCED TO NATIONAL GEODETIC VERTICAL DATUM (N.G.V.D.).

7525-P03



LANIER & ASSOCIATES
CONSULTING ENGINEERS
INCORPORATED

NEW ORLEANS, LA

HOUSTON, TX

SULPHUR

CITGO PIPELINE COMPANY

LOUISIANA

CLIFTON RIDGE TERMINAL
PROPOSED NEW MAINTENANCE DREDGING
PROPOSED DREDGE PLAN

DATE FEB '07
DESIGN MAY
DRAWN CAP
CHECK MAY
CONTRACT 7525
SHEET No.
3 OF 4

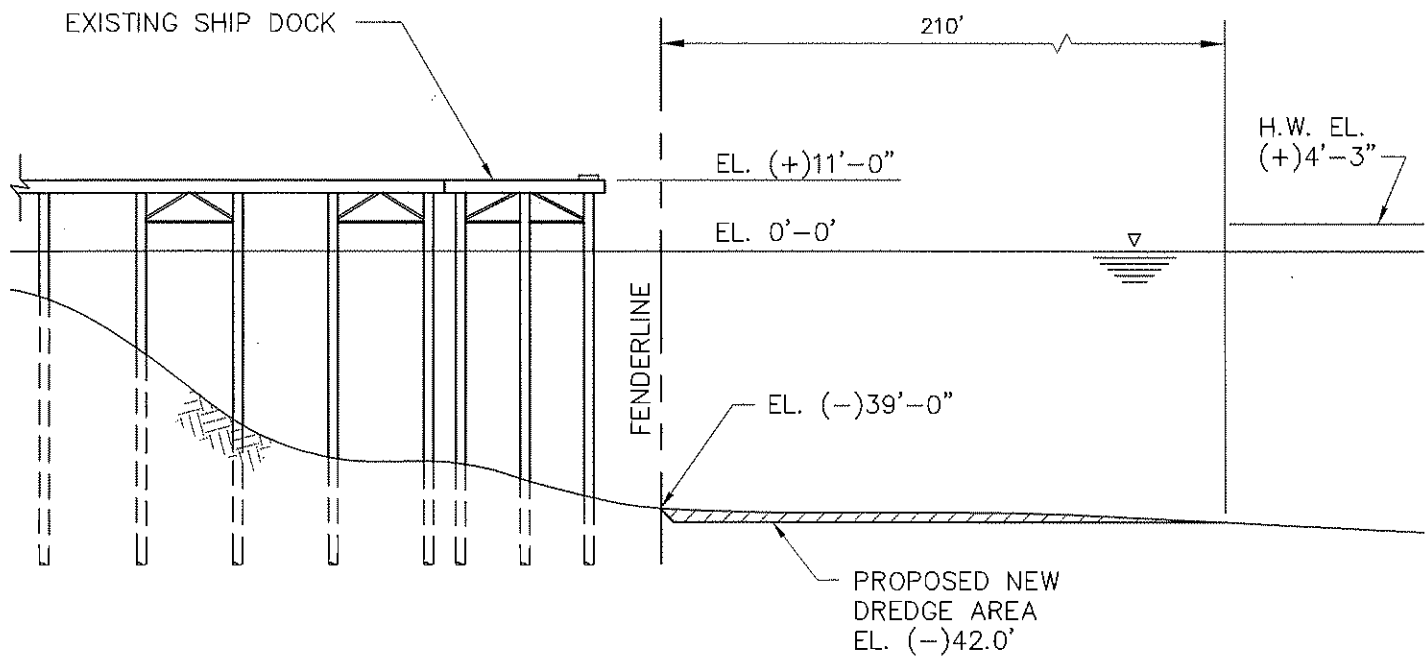

TYPICAL SECTION THRU SHIP DOCK

SCALE: 1" = 30'

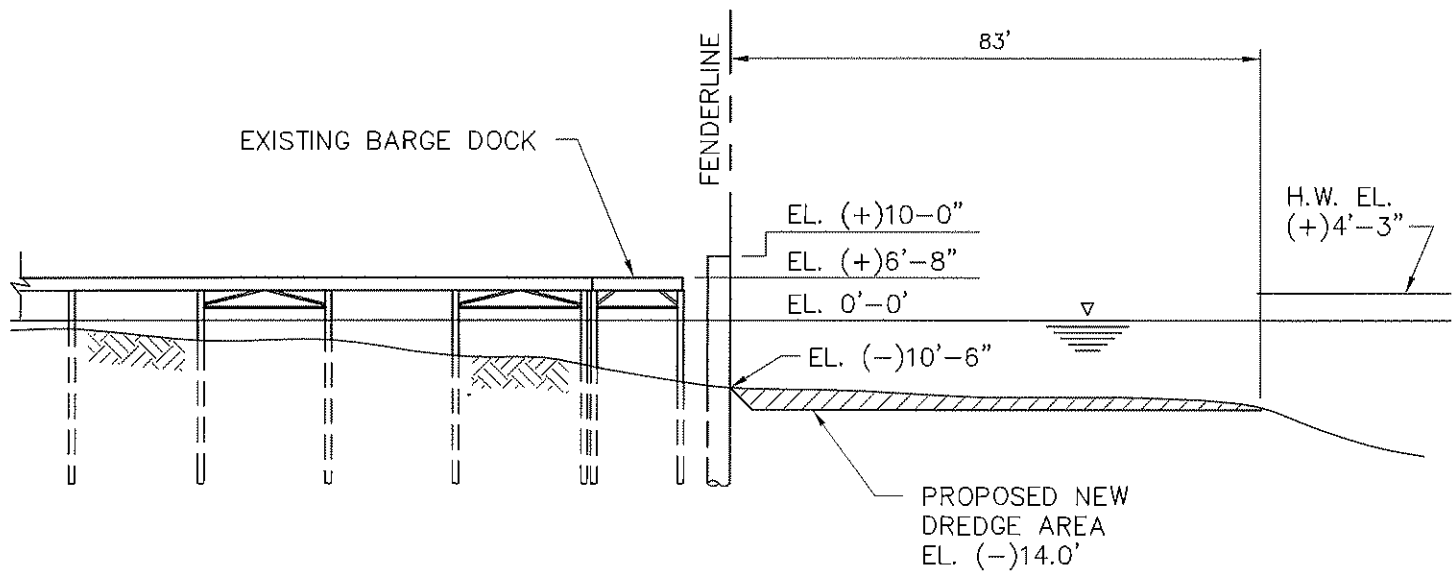

TYPICAL SECTION THRU BARGE DOCK

SCALE: 1" = 30'

NOTE:

ALL ELEVATIONS SHOWN REFER TO
NATIONAL GEODETIC VERTICAL DATUM (N.G.V.D.)

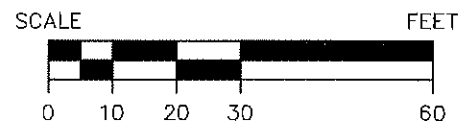

7525-P04



LANIER & ASSOCIATES
CONSULTING ENGINEERS
INCORPORATED

NEW ORLEANS, LA

HOUSTON, TX

SULPHUR

CITGO PIPELINE COMPANY

LOUISIANA

CLIFTON RIDGE TERMINAL
PROPOSED NEW MAINTENANCE DREDGING
CROSS SECTIONS

DATE FEB '07
DESIGN MAY
DRAWN CAP
CHECK MAY
CONTRACT 7525
SHEET No.
4 OF 4